

Ø 3,3

Platform: Ø 3,5 mm

Internal hex: h 2,1 mm

Core: Ø 2,6 mm

Apex: Ø 1,8 mm

Thread pitch: 0,6 mm

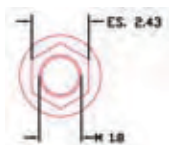

Polished neck



Length	Code
8,0	0113308
10,0	0113310
11,5	0113311
13,0	0113313
16,0	0113316

TTS



Length	Code
8,0	0113308TTS
10,0	0113310TTS
11,5	0113311TTS
13,0	0113313TTS
16,0	0113316TTS

Surgical protocol

First preparation	Round drill Ø 1,9	>	Cortical drill Ø 1,8				
	DS19S		DSP18				
	Max. speed 1.000 rpm		Max. speed 800 rpm				
	In compact bone						
Recommended sequence	Pilot drill Ø 2,0	>	Twist drill Ø 2,6	>	Countersink Ø 3,5	>	Bone tap* Ø 3,3
	DSS20S/L		DSS26S/L		CS35		CT33 / CTCA33
	Max. speed 800 rpm		Max. speed 500 rpm		Max. speed 250 rpm		Speed 15 to 18 rpm

Ø 3,75

Platform: Ø 4,0 mm

Internal hex: h 2,1 mm

Core: Ø 3,0 mm

Apex: Ø 2,1 mm

Thread pitch: 0,6 mm

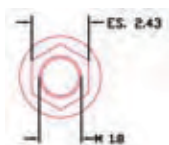

Polished neck



Length	Code
8,0	0113708
10,0	0113710
11,5	0113711
13,0	0113713
16,0	0113716

TTS



Length	Code
8,0	0113708TTS
10,0	0113710TTS
11,5	0113711TTS
13,0	0113713TTS
16,0	0113716TTS

Surgical protocol

First preparation	Round drill Ø 1,9	>	Cortical drill Ø 1,8						
	DS19S		DSP18						
	Max. speed 1.000 rpm		Max. speed 800 rpm						
	In compact bone								
Recommended sequence	Pilot drill Ø 2,0	>	Twist drill Ø 2,6	>	Twist drill Ø 3,2	>	Countersink Ø 4,0	>	Bone tap* Ø 3,75
	DSS20S/L		DSS26S/L		DSS32S/L		CS40		CT37 / CTCA37
	Max. speed 800 rpm		Max. speed 500 rpm		Max. speed 500 rpm		Max. speed 250 rpm		Speed 15 to 18 rpm

*Optional

Ø 4,5

Platform: Ø 5,0 mm

Internal hex: h 2,1 mm

Core: Ø 3,5 mm

Apex: Ø 2,7 mm

Thread pitch: 0,75 mm

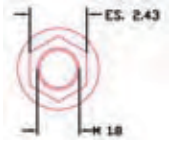

Polished neck



Length	Code
8,0	01I4508
10,0	01I4510
11,5	01I4511
13,0	01I4513
16,0	01I4516

TTS



Length	Code
8,0	01I4508TTS
10,0	01I4510TTS
11,5	01I4511TTS
13,0	01I4513TTS
16,0	01I4516TTS

Surgical protocol

First preparation

Round drill
Ø 1,9



Cortical drill
Ø 1,8

DS19S

DSP18

Max. speed
1.000 rpm

Max. speed
800 rpm

In compact bone

Recommended sequence

Pilot drill
Ø 2,0



Twist drill
Ø 2,6



Twist drill
Ø 3,2



Twist drill
Ø 3,8



Countersink
Ø 5,0



Bone tap*
Ø 4,5

DSS20S/L

DSS26S/L

DSS32S/L

DSS38S/L

CS50

CT45 / CTCA45

Max. speed
800 rpm

Max. speed
500 rpm

Max. speed
500 rpm

Max. speed
400 rpm

Max. speed
250 rpm

Speed
15 to 18 rpm

Ø 5,5

Platform: Ø 6,0 mm

Internal hex: h 2,1 mm

Core: Ø 4,5 mm

Apex: Ø 3,7 mm

Thread pitch: 0,75 mm

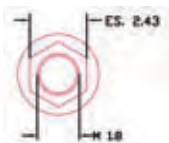

Polished neck



Length	Code
8,0	01I5508
10,0	01I5510
11,5	01I5511
13,0	01I5513

TTS



Length	Code
8,0	01I5508TTS
10,0	01I5510TTS
11,5	01I5511TTS
13,0	01I5513TTS

Surgical protocol

First preparation

Round drill
Ø 1,9



Cortical drill
Ø 1,8

DS19S

DSP18

Max. speed
1.000 rpm

Max. speed
800 rpm

In compact bone

Recommended sequence

Pilot drill
Ø 2,0



Twist drill
Ø 2,6



Twist drill
Ø 3,2



Twist drill
Ø 3,8



Twist drill
Ø 4,2



Twist drill
Ø 4,8



Countersink
Ø 6,0



Bone tap*
Ø 5,5

DSS20S/L

DSS26S/L

DSS32S/L

DSS38S/L

DSS42S/L

DSS48S/L

CS60

CT55 / CTCA55

Max. speed
800 rpm

Max. speed
500 rpm

Max. speed
500 rpm

Max. speed
500 rpm

Max. speed
500 rpm

Max. speed
400 rpm

Max. speed
250 rpm

Speed
15 to 18 rpm

*Optional

Ø 3,3

Platform: Ø 4,1 mm

External hex: h 0,7 mm

Neck: h 0,7 mm

Thread pitch 0,6 mm



Polished neck



Length	Code
10,0	01IX3310
11,5	01IX3311
13,0	01IX3313
16,0	01IX3316

TTS



Length	Code
10,0	01IX3310TTS
11,5	01IX3311TTS
13,0	01IX3313TTS
16,0	01IX3316TTS

Surgical protocol

First preparation

Round drill
Ø 1,9



Cortical drill
Ø 1,8

DS19S

DSP18

Max. speed
1.000 rpm

Max. speed
800 rpm

In compact bone

Recommended sequence

Pilot drill
Ø 2,0



Twist drill
Ø 2,6



Countersink
Ø 3,3



Bone tap*
Ø 3,3

DSS20S/L

DSS26S/L

CSX33

CT33 / CTCA33

Max. speed
800 rpm

Max. speed
500 rpm

Max. speed
250 rpm

Speed
15 to 18 rpm

Ø 3,75

Platform: Ø 4,1 mm

External hex: h 0,7 mm

Neck: h 0,7 mm

Thread pitch 0,6 mm



Polished neck



Length	Code
8,0	01IX3708
10,0	01IX3710
11,5	01IX3711
13,0	01IX3713
16,0	01IX3716
18,0	01IX3718
20,0	01IX3720

TTS



Length	Code
8,0	01IX3708TTS
10,0	01IX3710TTS
11,5	01IX3711TTS
13,0	01IX3713TTS
16,0	01IX3716TTS
18,0	01IX3718TTS
20,0	01IX3720TTS

Surgical protocol

First preparation

Round drill
Ø 1,9



Cortical drill
Ø 1,8

DS19S

DSP18

Max. speed
1.000 rpm

Max. speed
800 rpm

In compact bone

Recommended sequence

Pilot drill
Ø 2,0



Twist drill
Ø 2,6



Twist drill
Ø 3,2



Countersink
Ø 4,0



Bone tap*
Ø 3,75

DSS20S/L

DSS26S/L

DSS32S/L

CSX40

CT37 / CTCA37

Max. speed
800 rpm

Max. speed
500 rpm

Max. speed
500 rpm

Max. speed
250 rpm

Speed
tra 15-18 rpm

*Optional

Ø 5,0

Platform: Ø 5,0 mm

External hex: h 0,7 mm

Neck: h 0,7 mm

Thread pitch: 0,75 mm

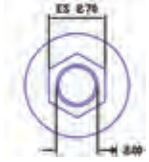

Polished neck



Length	Code
8,0	01IX5008
10,0	01IX5010
11,5	01IX5011
13,0	01IX5013

TTS

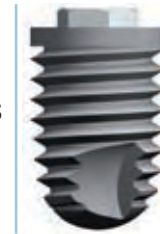

Length	Code
8,0	01IX5008TTS
10,0	01IX5010TTS
11,5	01IX5011TTS
13,0	01IX5013TTS

Surgical protocol

First preparation

Round drill
Ø 1,9



Cortical drill
Ø 1,8

DS19S

DSP18

Max. speed
1.000 rpm

Max. speed
800 rpm

In compact bone

Recommended sequence

Pilot drill
Ø 2,0



Twist drill
Ø 2,6



Twist drill
Ø 3,2



Twist drill
Ø 3,8



Twist drill
Ø 4,2



Bone tap*
Ø 5,0

DSS20S/L

DSS26S/L

DSS32S/L

DSS38S/L

DSS42S/L

CT50 / CTCA50

Max. speed
800 rpm

Max. speed
500 rpm

Max. speed
500 rpm

Max. speed
500 rpm

Max. speed
400 rpm

Speed
tra 15-18 rpm

*Optional

Ø 3,75

Platform: Ø 4,0 mm

Internal hex:
h 2,1 mm

Body:
Gradually tapered

Thread pitch:
0,6 mm

Tapered apex:
Ø 2,25 mm

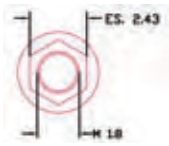

Polished neck



Length	Code
10,0	011C3710
11,5	011C3711
13,0	011C3713
16,0	011C3716

TTS



Length	Code
10,0	011C3710TTS
11,5	011C3711TTS
13,0	011C3713TTS
16,0	011C3716TTS

Surgical protocol

First preparation

Round drill Ø 1,9	Cortical drill Ø 1,8
DS19S	DSP18
Max. speed 1.000 rpm	Max. speed 800 rpm

In compact bone

Recommended sequence

Pilot drill Ø 2,0	Twist drill Ø 2,3	Twist drill Ø 3,2	Countersink ¹⁾ Ø 4,0
DSS20S	DSS23S	DSS32S	CS40
DSS20L	DSS23L	DSS32L	
Max. speed 800 rpm	Max. speed 500 rpm	Depth only 4 mm Max. speed 500 rpm	Depth only 1 mm Max. speed 250 rpm

In soft bone
Exp. Osteotome Ø 4,0
OE4008
OE4010
OE4011
OE4013
OE4016

¹⁾ In case of poor bone quality (D4) **the countersink has not to be used** because it could remove the marginal crestal bone available, increasing the gap between the interface bone-implant.

Ø 4,75	Platform: Ø 5,0 mm	Internal hex: h 2,1 mm	Body: Gradually tapered	Thread pitch: 0,75 mm	Tapered apex: Ø 2,75 mm
---------------	--------------------	---------------------------	----------------------------	--------------------------	----------------------------

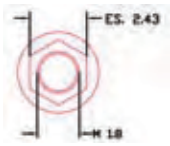

Polished neck



Length	Code
10,0	011C4710
11,5	011C4711
13,0	011C4713
16,0	011C4716

TTS



Length	Code
10,0	011C4710TTS
11,5	011C4711TTS
13,0	011C4713TTS
16,0	011C4716TTS

Surgical protocol

Round drill Ø 1,9	Cortical drill Ø 1,8
DS19S	DSP18
Max. speed 1.000 rpm	Max. speed 800 rpm

Recommended sequence

Pilot drill Ø 2,0	Twist drill Ø 2,8	Twist drill Ø 3,2	Twist drill Ø 3,8	Countersink ¹⁾ Ø 5,0
DSS20S	DSS28S	DSS32S	DSS38S	CS50
DSS20L	DSS28L	DSS32L	DSS38L	
Max. speed 800 rpm	Max. speed 500 rpm	Depth only 4 mm Max. speed 500 rpm	Depth only 4 mm Max. speed 400 rpm	Depth only 1 mm Max. speed 250 rpm

In soft bone

Exp. Osteotome Ø 5,0
OE5008
OE5010
OE5011
OE5013
OE5016

¹⁾ In case of poor bone quality (D4) **the countersink has not to be used** because it could remove the marginal crestal bone available, increasing the gap between the interface bone-implant.

Ø 5,75	Platform: Ø 6,0 mm	Internal hex: h 2,1 mm	Body: Gradually tapered	Thread pitch: 0,75 mm	Tapered apex: Ø 3,75 mm
---------------	--------------------	---------------------------	----------------------------	--------------------------	----------------------------

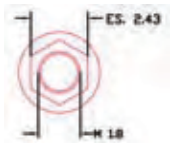

Polished neck



Length	Code
10,0	01IC5710
11,5	01IC5711
13,0	01IC5713

TTS



Length	Code
10,0	01IC5710TTS
11,5	01IC5711TTS
13,0	01IC5713TTS

Surgical protocol

First preparation

Round drill Ø 1,9	Cortical drill Ø 1,8
DS19S	DSP18
Max. speed 1.000 rpm	Max. speed 800 rpm

In compact bone

Recommended sequence

Pilot drill Ø 2,0	Twist drill Ø 2,6	Twist drill Ø 3,2	Twist drill Ø 3,8	Twist drill Ø 4,2	Twist drill Ø 4,8	Countersink ¹⁾ Ø 6,0
DSS20S	DSS26S	DSS32S	DSS38S	DSS42S	DSS48S	CS60
DSS20L	DSS26L	DSS32L	DSS38L	DSS42L	DSS48L	
Max. speed 800 rpm	Max. speed 500 rpm	Max. speed 500 rpm	Max. speed 500 rpm	Depth only 4 mm Max. speed 500 rpm	Depth only 4 mm Max. speed 400 rpm	Depth only 1 mm Max. speed 250 rpm

In soft bone

Exp. Osteotome Ø 6,0
OE6010
OE6011
OE6013

¹⁾ In case of poor bone quality (D4) **the countersink has not to be used** because it could remove the marginal crestal bone available, increasing the gap between the interface bone-implant.

Ø 4,0	Platform: Ø 4,0 mm	Internal hex: h 2,1 mm	Body: Gradually tapered	Thread pitch: 1,3 mm	Tapered apex: Ø 2,25 mm
--------------	--------------------	---------------------------	----------------------------	-------------------------	----------------------------

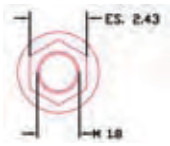

Polished neck



Length	Code
8,0	01IC4008
10,0	01IC4010
11,5	01IC4011
13,0	01IC4013
16,0	01IC4016

TTS



Length	Code
8,0	01IC4008TTS
10,0	01IC4010TTS
11,5	01IC4011TTS
13,0	01IC4013TTS
16,0	01IC4016TTS

Surgical protocol

First preparation

Round drill Ø 1,9	Cortical drill Ø 1,8
DS19S	DSP18
Max. speed 1.000 rpm	Max. speed 800 rpm

In compact bone

Recommended sequence

Pilot drill Ø 2,0	Twist drill Ø 2,3	Twist drill Ø 3,2	Countersink ¹⁾ Ø 4,0
DSS20S	DSS23S	DSS32S	CS40
DSS20L	DSS23L	DSS32L	
Max. speed 800 rpm	Max. speed 500 rpm	Depth only 4 mm Max. speed 400 rpm	Depth only 1 mm Max. speed 250 rpm

In soft bone	
Exp. Osteotome Ø 4,0	
OE4008	
OE4010	
OE4011	
OE4013	
OE4016	

¹⁾ In case of poor bone quality (D4) **the countersink has not to be used** because it could remove the marginal crestal bone available, increasing the gap between the interface bone-implant.

Ø 5,0	Platform: Ø 5,0 mm	Internal hex: h 2,1 mm	Body: Gradually tapered	Thread pitch: 1,5 mm	Tapered apex: Ø 2,75 mm
--------------	--------------------	---------------------------	----------------------------	-------------------------	----------------------------

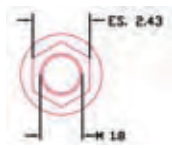

Polished neck



Length	Code
8,0	01C5008
10,0	01C5010
11,5	01C5011
13,0	01C5013
16,0	01C5016

TTS



Length	Code
8,0	01C5008TTS
10,0	01C5010TTS
11,5	01C5011TTS
13,0	01C5013TTS
16,0	01C5016TTS

Surgical protocol

First preparation

Round drill Ø 1,9	Cortical drill Ø 1,8
DS19S	DSP18
Max. speed 1.000 rpm	Max. speed 800 rpm

Recommended sequence

Pilot drill Ø 2,0	Twist drill Ø 2,8	Twist drill Ø 3,2	Twist drill Ø 3,8	Countersink ¹⁾ Ø 5,0
DSS20S	DSS28S	DSS32S	DSS38S	CS50
DSS20L	DSS28L	DSS32L	DSS38L	
Max. speed 800 rpm	Max. speed 500 rpm	Depth only 4 mm Max. speed 500 rpm	Depth only 4 mm Max. speed 400 rpm	Depth only 1 mm Max. speed 250 rpm

In soft bone
Exp. Osteotome Ø 5,0
OE5008
OE5010
OE5011
OE5013
OE5016

¹⁾ In case of poor bone quality (D4) **the countersink has not to be used** because it could remove the marginal crestal bone available, increasing the gap between the interface bone-implant.

Ø 6,0	Platform: Ø 6,0 mm	Internal hex: h 2,1 mm	Body: Gradually tapered	Thread pitch: 1,5 mm	Tapered apex: Ø 3,75 mm
--------------	--------------------	---------------------------	----------------------------	-------------------------	----------------------------

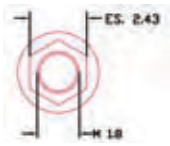

Polished neck



Length	Code
8,0	01IC6008
10,0	01IC6010
11,5	01IC6011
13,0	01IC6013

TTS



Length	Code
8,0	01IC6008TTS
10,0	01IC6010TTS
11,5	01IC6011TTS
13,06	01IC6013TTS

Surgical protocol

First preparation

Round drill Ø 1,9	Cortical drill Ø 1,8
DS19S	DSP18
Max. speed 1.000 rpm	Max. speed 800 rpm

In compact bone

Recommended sequence

Pilot drill Ø 2,0	Twist drill Ø 2,6	Twist drill Ø 3,2	Twist drill Ø 3,8	Twist drill Ø 4,2	Twist drill Ø 4,8	Countersink ¹⁾ Ø 6,0
DSS20S	DSS26S	DSS32S	DSS38S	DSS42S	DSS48S	CS60
DSS20L	DSS26L	DSS32L	DSS38L	DSS42L	DSS48L	
Max. speed 800 rpm	Max. speed 500 rpm	Max. speed 500 rpm	Max. speed 500 rpm	Depth only 4 mm Max. speed 500 rpm	Depth only 4 mm Max. speed 400 rpm	Depth only 1 mm Max. speed 250 rpm

In soft bone

Exp. Osteotome
Ø 6,0

OE6008

OE6010

OE6011

OE6013

¹⁾ In case of poor bone quality (D4) **the countersink has not to be used** because it could remove the marginal crestal bone available, increasing the gap between the interface bone-implant.

Ø 4,0	Platform: Ø 4,1 mm	External hex: h 0,7 mm	Neck: h 0,7 mm	Body: Gradually tapered	Thread pitch: 1,3 mm	Tapered apex: Ø 2,25 mm
--------------	--------------------	---------------------------	-------------------	----------------------------	-------------------------	----------------------------



Polished neck



Length	Code
8,0	01ICX4008
10,0	01ICX4010
11,5	01ICX4011
13,0	01ICX4013
16,0	01ICX4016

TTS



Length	Code
8,0	01ICX4008TTS
10,0	01ICX4010TTS
11,5	01ICX4011TTS
13,0	01ICX4013TTS
16,0	01ICX4016TTS

Surgical protocol

First preparation

Round drill Ø 1,9	Cortical drill Ø 1,8
DS19S	DSP18
Max. speed 1.000 rpm	Max. speed 800 rpm

Recommended sequence

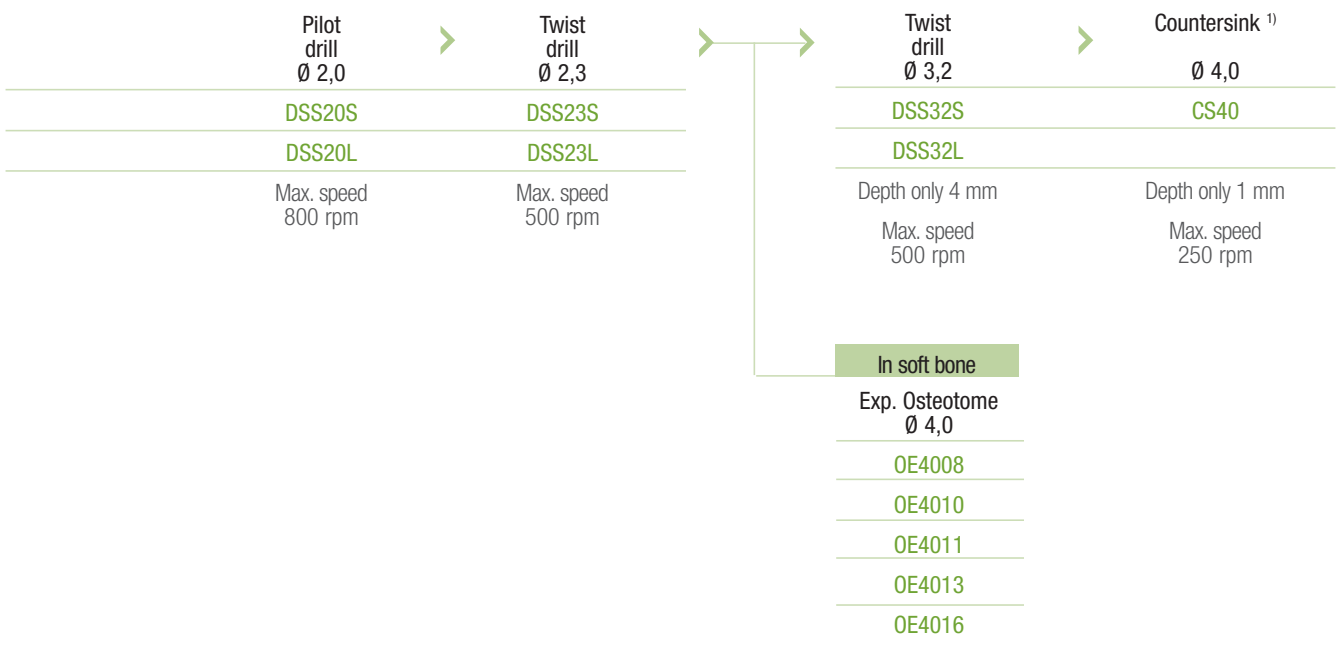

¹⁾ In case of poor bone quality (D4) **the countersink has not to be used** because it could remove the marginal crestal bone available, increasing the gap between the interface bone-implant.

Ø 5,0	Platform: Ø 5,0 mm	External hex: h 0,7 mm	Neck: h 0,85 mm	Body: Gradually tapered	Thread pitch: 1,6 mm	Tapered apex: Ø 2,75 mm
--------------	--------------------	---------------------------	--------------------	----------------------------	-------------------------	----------------------------



Polished neck



Length	Code
8,0	01ICX5008
10,0	01ICX5010
11,5	01ICX5011
13,0	01ICX5013

TTS



Length	Code
8,0	01ICX5008TTS
10,0	01ICX5010TTS
11,5	01ICX5011TTS
13,0	01ICX5013TTS

Surgical protocol

First preparation

Round drill Ø 1,9	Cortical drill Ø 1,8
DS19S	DSP18
Max. speed 1.000 rpm	Max. speed 800 rpm

In compact bone

Recommended sequence

Pilot drill Ø 2,0	Twist drill Ø 2,8	Twist drill Ø 3,2	Twist drill Ø 3,8	Countersink ¹⁾ Ø 5,0
DSS20S	DSS28S	DSS32S	DSS38S	CS50
DSS20L	DSS28L	DSS32L	DSS38L	
Max. speed 800 rpm	Max. speed 500 rpm	Depth only 4 mm Max. speed 500 rpm	Depth only 4 mm Max. speed 400 rpm	Depth only 1 mm Max. speed 250 rpm

In soft bone
Exp. Osteotome Ø 5,0
0E5008
0E5010
0E5011
0E5013

¹⁾ In case of poor bone quality (D4) **the countersink has not to be used** because it could remove the marginal crestal bone available, increasing the gap between the interface bone-implant.